

three blue ducks

ROSEBERY PARTIES & CELEBRATIONS

three blue ducks





three blue ducks

**GOOD FOOD.
GREAT COMPANY.
A PLACE TO CELEBRATE.**

Set within a heritage-listed warehouse in Sydney's inner south, Three Blue Ducks Rosebery offers a vibrant, welcoming setting for celebrations of all kinds.

From milestone birthdays and engagement parties to hens lunches and family gatherings, we create events that feel generous, relaxed and effortlessly special - with seasonal food, warm service and spaces that can be styled to suit your occasion.



three blue ducks

WHY CELEBRATE AT THE DUCKS

Some occasions call for more than just a table booking.

At Three Blue Ducks, we create celebrations that feel thoughtful and effortless, whether you're gathering family, friends or both.

What makes the Ducks ideal for celebrations:

- A beautiful heritage-listed warehouse setting
- Seasonal menus designed for sharing
- Flexible indoor and outdoor spaces
- An experienced team to help plan and host your event
- A buzzing atmosphere that suits all ages

Whether it's easy and casual or a little more polished, we'll deliver a celebration to suit your style.



three blue ducks

TYPES OF CELEBRATIONS WE HOST

We regularly host a wide range of private events, including:

- Birthday celebrations and milestone events
- Bat mitzvahs and bar mitzvahs
- Hens parties and pre-wedding gatherings
- Christenings, baptisms and family celebrations
- Engagement parties and anniversaries
- Long lunches and intimate dinners

If you're celebrating something special, our team will help find the right space, format and menu for your group.



three blue ducks

THE LAYOUT & SPACES

Three Blue Ducks Rosebery offers several distinct spaces that can be booked individually or combined depending on your guest numbers and event style.

Available spaces include:

- The Restaurant
- The Rosella Room
- The Courtyard
- The Deck

Each space offers a different feel, and our team can recommend the best option based on your guest numbers and the atmosphere you're after.

THE LAYOUT

The entire venue can be booked exclusively, including the deck, courtyard and main dining area. The Rosella Room located upstairs can be added for an additional hire fee.

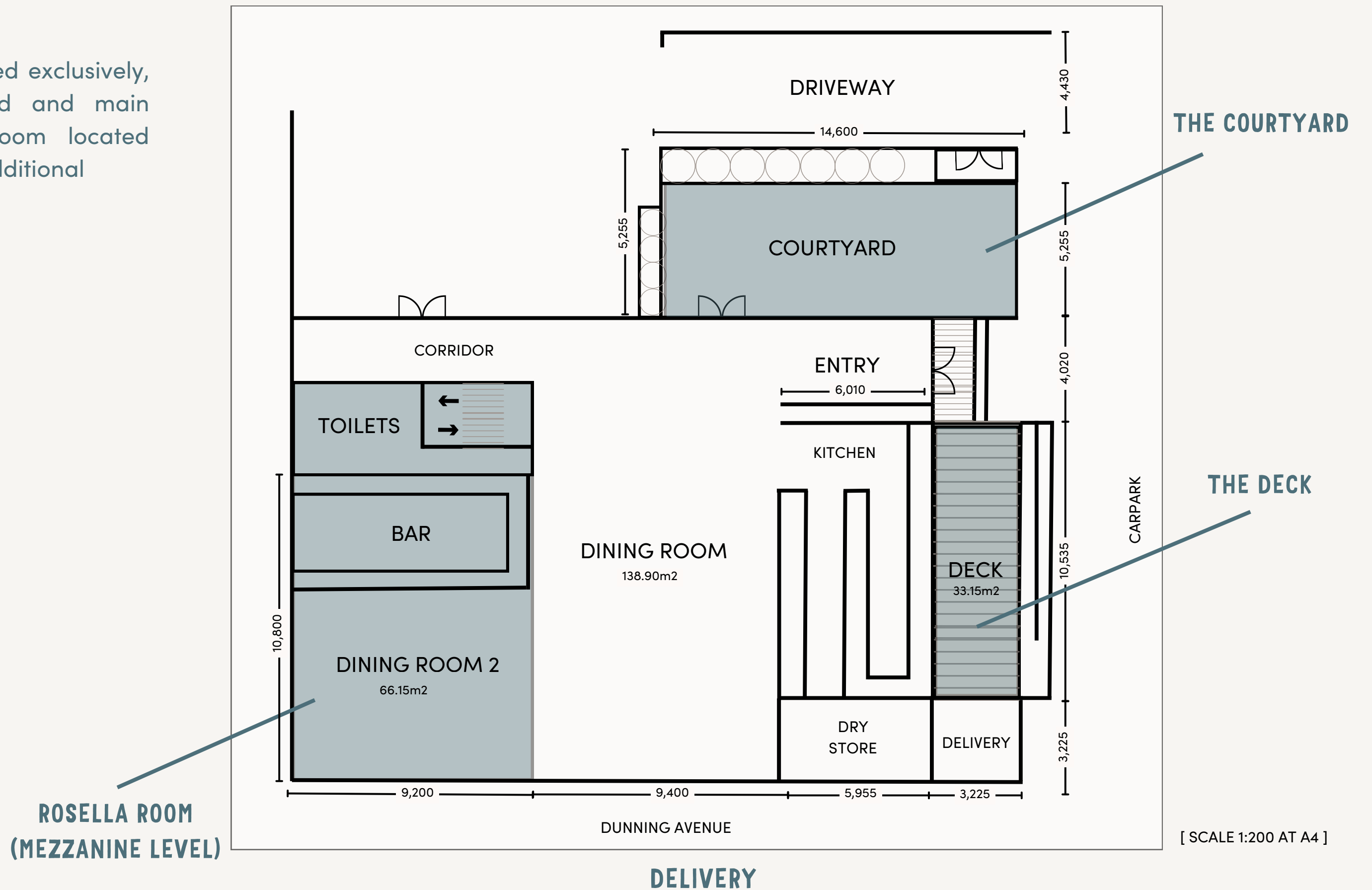

three blue ducks





three blue ducks

THE RESTAURANT

The Restaurant is our largest and most versatile space, ideal for bigger celebrations, offering space to gather everyone together comfortably.

With soaring ceilings, exposed beams, whitewashed brickwork and an open kitchen, it creates a lively backdrop for milestone birthdays, engagement parties and big group gatherings.

Booking the restaurant provides exclusive use of the entire ground level venue, including the courtyard and deck.

CAPACITY

Cocktail: up to 220 guests | Seated: up to 180 guests

Shared feasting menus work beautifully in this space, with optional add-ons such as grazing tables, arrival cocktails, or champagne and oysters to elevate the experience.



three blue ducks

THE ROSELLA ROOM

The Rosella Room is a private event space located upstairs, offering a more intimate setting.

With high ceilings, natural light, and its own dedicated bar area, it's perfect for birthdays, engagement parties, hens gatherings and family celebrations where exclusivity is key.

One of the standout features of the Rosella Room is its flexibility - the space can be completely transformed to suit your brief, from elegant long-table dinners to vibrant cocktail celebrations.

CAPACITY

Cocktail: up to 100 guests | Seated: up to 80 guests

Exclusive use includes dedicated service staff and flexible furniture styling options to suit the tone of your event. Shared feasting menus and canapé-style events both work well in this space, with optional add-ons available.



three blue ducks

THE COURTYARD

Our sun-drenched courtyard offers a relaxed outdoor setting, nestled amongst olive trees and grapevines.

A popular choice for spring and summer celebrations, the courtyard brings a vibrant yet easy atmosphere to any gathering, and is an ideal for cocktail-style parties or seated long lunches.

CAPACITY

Cocktail: up to 50 guests | Seated: up to 36 guests

The Courtyard includes exclusive use, dedicated service staff and a range of styling options to elevate the space if desired. Shared feasting menus and canapé-style events both work well in this space, with optional add-ons available.



three blue ducks

THE DECK

The Deck is a versatile semi-private space within the venue, ideal for smaller celebrations and intimate gatherings.

It works beautifully for long lunches, birthdays and hens parties, particularly during spring and summer when the space feels light and open.

The Deck can also be used as an entry feature for larger functions, or as a dedicated beverage station for arrival drinks during stand up events.

CAPACITY

Cocktail: up to 40 guests | Seated: up to 36 guests

The Deck includes exclusive use, dedicated service staff and can be arranged in a variety of layouts. Shared feasting menus and canapé-style events both work well in this space, with optional add-ons available.



three blue ducks

FOOD & DRINKS

Food is central to every celebration at the Ducks.

Our menus are designed around seasonal produce sourced from local farmers and producers, with a focus on shared dining that encourages connection.

We offer:

- Shared feasting menus
- Canapés and grazing options
- Curated beverage packages or drinks on consumption
- Accommodation for dietary requirements

Menu options can be tailored to suit your celebration and group.



three blue ducks

INVESTMENT

We know every celebration is different, so pricing at Three Blue Ducks is kept flexible.

Minimum spends vary depending on the size and style of your event, as well as the date and space chosen.

Once you've shared a few details with our team, we'll put together a tailored proposal that works for your celebration and aligns with your budget.



three blue ducks

WHAT'S INCLUDED

All celebration bookings include:

- Dedicated event planning
- Menu and beverage planning
- Setup and pack-down
- Professional service staff
- In-house furniture, tableware and glassware
- On-the-day support from our dedicated front of house team

Optional styling, entertainment and additional touches can be arranged on request.



three blue ducks

THE NEXT STEP

If you're planning a celebration and looking for a relaxed, beautiful setting with great food and thoughtful service, we'd love to help make it even more special.

Get in touch with our events team to discuss your date, guest numbers and vision, and we'll create a personalised proposal.

Our **Food & Beverage Package** is also available for download.

three blue ducks

